



Greenspace Flex

RS378B P42 927 PSU-E NB M102

- Electronic transformer - - - 18°

GreenSpace Flex is performance portfolio dedicated to Hospitality segment for GC/GM countries. With modular design concept, the light engines and different trims could have multiply of combination to satisfy diversified customer's requirement.

Product data

General Information	
Driver included	Yes
Number of gear units	1 unit
Light source engine type	LED

Light Technical	
Luminous Flux	3,780 lumen
Correlated Color Temperature (Nom)	2700 K
Luminous Efficacy (rated) (Nom)	90 lm/W
Color rendering index (CRI)	>90
Light source color	927 warm white
Optical cover/lens type	-
Luminaire light beam spread	18°

Operating and Electrical	
Input Voltage	220 to 240 V
Line Frequency	50 or 60 Hz
Input Frequency	50 or 60 Hz
Average CLO power consumption	2815 W
Power Consumption	42 W
Power Factor (Fraction)	0.9

Connection	External connector
Cable	-
Number of products on MCB of 16 A type B	-

Temperature	
Ambient temperature range	-20 to +45 °C

Controls and Dimming	
Dimmable	No
Driver/power unit/transformer	Electronic transformer
Control interface	-
Constant light output	No

Mechanical and Housing	
Housing Material	Aluminum Alloy
Optic material	Polymethyl methacrylate
Optical cover/lens material	-
Fixation material	Aluminum
Housing Color	Dark gray
Optical cover/lens finish	-
Overall length	0 mm

Greenspace Flex

Overall width	0 mm
Overall height	116 mm
Overall diameter	102 mm
Dimensions (Height x Width x Depth)	116 x 0 x 0 mm

Approval and Application

Ingress protection code	IP20 [Finger-protected]
Mech. impact protection code	IK04 [0.5 J standard plus]
Protection class IEC	Safety class II
Glow-wire test	Temperature 600 °C, duration 30 s
CE mark	-
Warranty period	3 years
EU RoHS compliant	Yes

Initial Performance (IEC Compliant)

Luminous flux tolerance	+/-10%
Initial chromaticity	SDCM<3
Power consumption tolerance	+/-10%

Over Time Performance (IEC Compliant)

Median useful life L80B50	50.000 hour(s)
---------------------------	----------------

Application Conditions

Maximum dim level	Not applicable
Suitable for random switching	No

Product Data

Full product code	911401721612
Order product name	RS378B P42 927 PSU-E NB M102
Order code	911401721612
Numerator - Quantity Per Pack	1
Numerator - Packs per outer box	12
Material number (12NC)	911401721612
Full product name	RS378B P42 927 PSU-E NB M102



Dimensional drawing

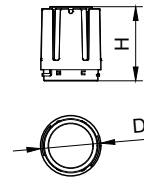
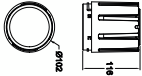

Modular Type	D, mm	H, mm
RS378B P6/P11 M55	55	49
RS378B P15 M55	55	49
RS378B P24 M70	70	90
RS378B P33 M87	87	107
RS378B P42 M102	102	116

